

SHOCK ABSORBER KIT FOR
ISUZU D-MAX RG

Front Shock Absorber Kit.....Page 1-10

Rear Shock Absorber Kit.....Page 11-14

Mounting Instructions



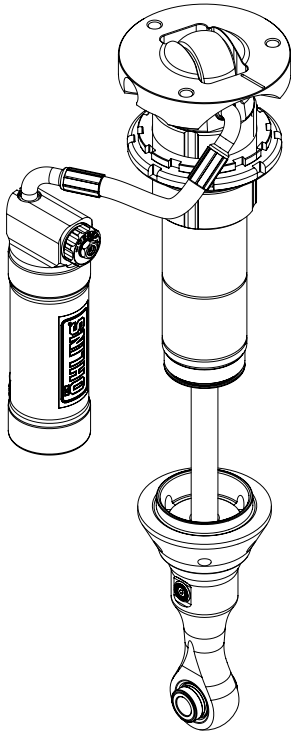

Note!

Please note that this image is a general representation of the product and may differ slightly from your product.

Note!

Please note that during storage and transportation, especially at high ambient temperature, some of the oil and grease used for assembling may leak and stain the packaging. This is in no way detrimental to the product, wipe off the excessive oil/grease with a cloth.

Note!

Before installing this product, check the contents of the kit. If anything is missing, please check an Öhlins dealer.

Kit Contents

Description	Part No	Pcs
1.1 Shock absorber LH	ISV 1X00	1
1.2 Shock absorber RH	ISV 2X00	1
2 Washer	00543-12	2
3 Spring clip	62429-01	2
4 Lock ring	62427-01	4
5 Bracket, Reservoir	60006-50	2
6 Spacer	61125-10	2
7 Screw M10x25x1.25	00429-33	4
8 Screw M10x25x1.5	00429-34	6
9 Washer	00426-08	10
10 Reservoir bracket	05378-20	4
11 Screw M5x22	01046-26	4
12 Screw M5x16	01046-18	8
13 Lock nut M5	00430-04	12
14 Spacer	60049-05	4
15 Screw M6x25x1.0	01046-17	4
16 Washer	00426-04	4
17 Washer	00426-07	6
18 Lock nut M6	00430-02	4
19 Bracket	60006-51	2
20 Screw M6x20x1.0	01046-16	2
21 C-Spanner	60710-03	1
22 R&T C-Spanner	01796-01	1
23 Sticker set "ÖHLINS"	10207-01	1
24 Owners manual	07440-06	1

Warning!

Before installing this product, read the Öhlins Owner's Manual. The shock absorber is an important part of your vehicle and will affect the stability.

Shock Absorber Kit for Isuzu D-Max RG Front

ISV 1X00

ISV 2X00

Mounting Instructions



MOUNTING INSTRUCTIONS

⚠ Warning!

It is advisable to have an Öhlins dealer install the shock absorber.

⚠ Warning!

If working on a raised vehicle, ensure it is securely supported so that it will not tip over.

👁 Note!

Before mounting this product clean the vehicle thoroughly.

👁 Note!

When working on this product, always see the Vehicle Service Manual for vehicle specific procedures and important data.

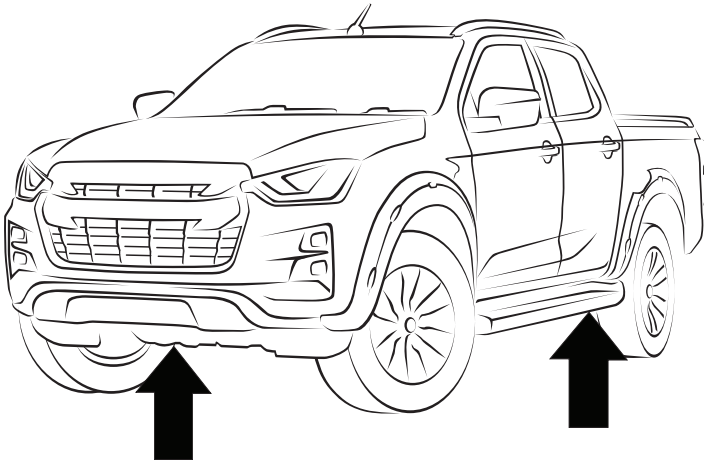

1
Lift the vehicle by using a suitable car lift.

👁 Note!

Refer to the vehicle service manual for the recommended lift points.

2
Remove the front wheels.

MOUNTING INSTRUCTIONS

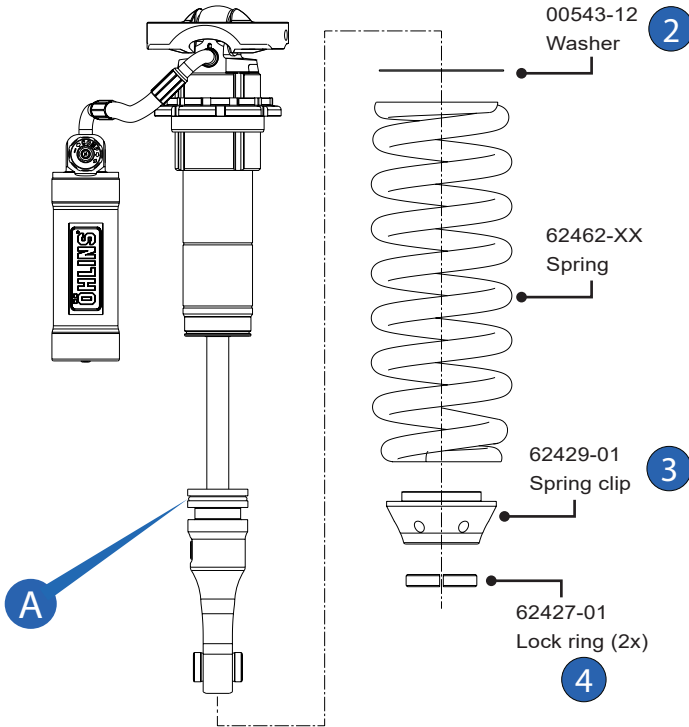

3 Spring Installation

3.1 Pre-compress the spring by using a spring compressor.

3.2 Install the washer (2) underneath the pre-load adjuster nuts.

3.2 Install the spring onto the damper body.

3.3 Apply penetrating oil (WD-40 or similar) to the O-ring (A) then install the spring clip (3) through the end-eye and lock it in place by using the 2 lock rings (4).

👁 **Note!**

For spring recommendation and preload see page 10.

MOUNTING INSTRUCTIONS

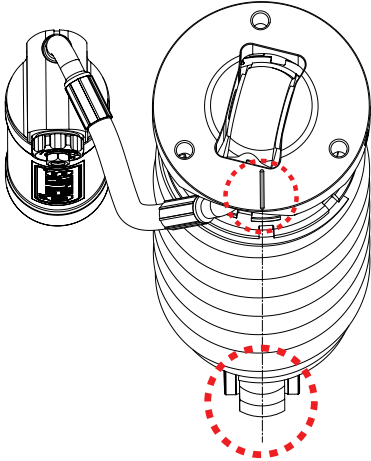

Left Side

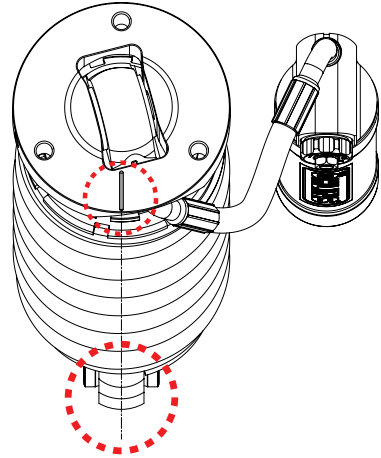

Right Side

Note!

3.4 Make sure that the end eye direction is aligned with the marking on the top plate.

3.5 Release the spring from the spring compressor making sure the spring clip and the lock rings are seated properly.

Note!

When installing the springs, reservoir hose and rebound adjuster must be pointed as per picture above.

MOUNTING INSTRUCTIONS

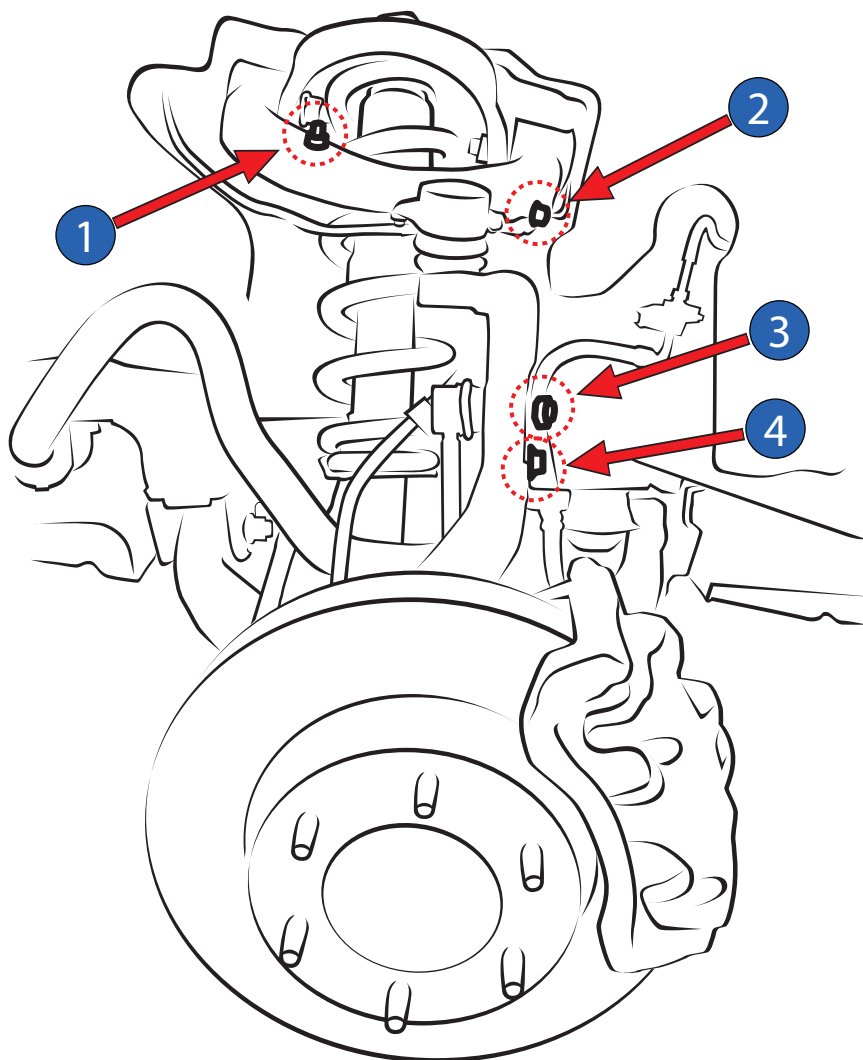

4

Loosen the wiring cable bracket screws ①, ② and the anti-rollbar link ③ then loosen brake line bracket screw ④.

MOUNTING INSTRUCTIONS

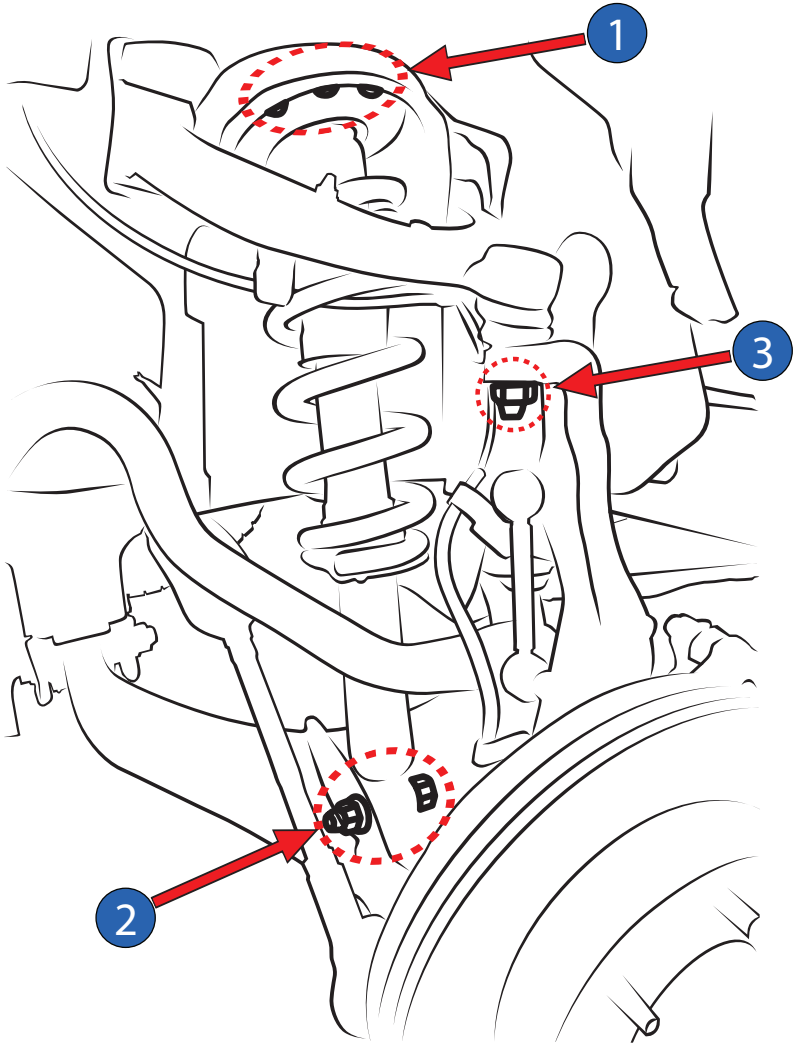

5
Loosen the 3 top mount screws ① and lower mount screw ②. Then loosen the upper control arm ball joint screw ③.

MOUNTING INSTRUCTIONS

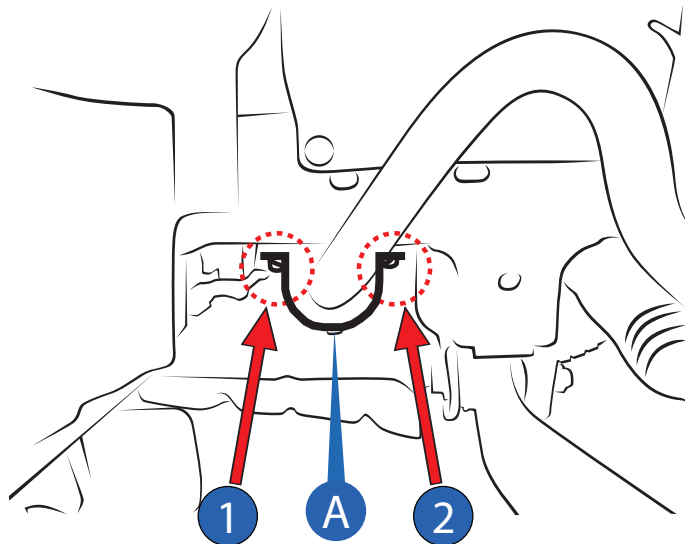

6

Remove the OEM Anti-rollbar clamp bracket **A** by loosening the screws **1** and **2**.

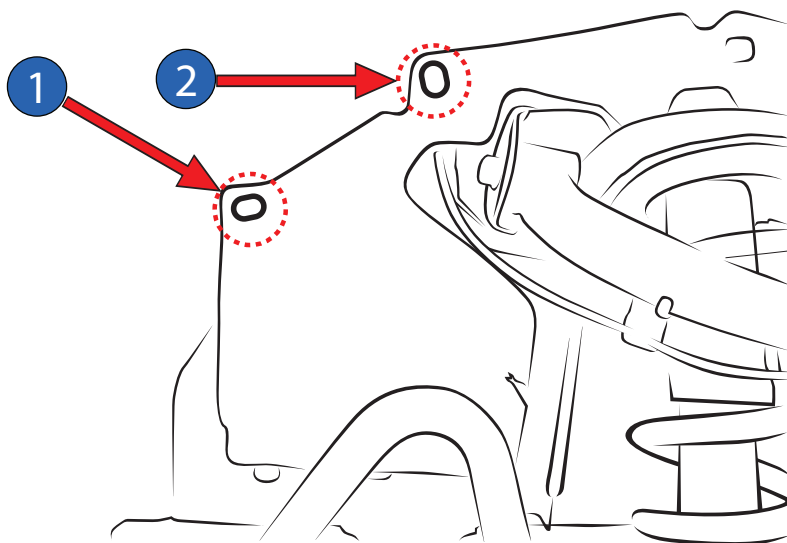

7

Remove the plastic clips **1** and **2**.

MOUNTING INSTRUCTIONS

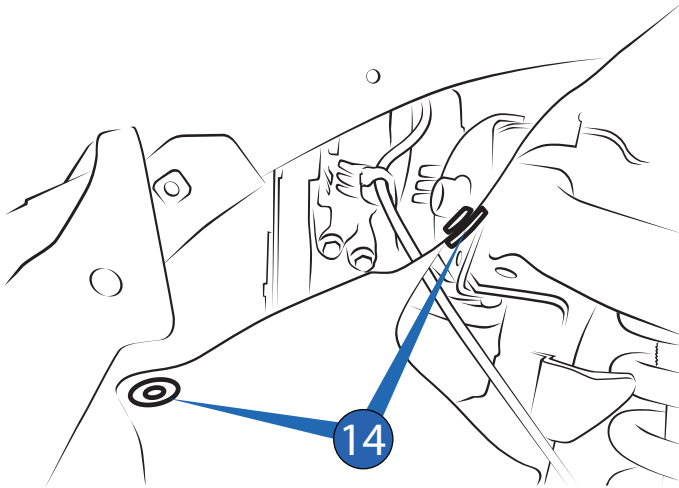

8

Install the 2 spacers 60049-05 (14) to the cover rubber replacement the plastic clips by facing the bigger diameter side outward of the vehicle.

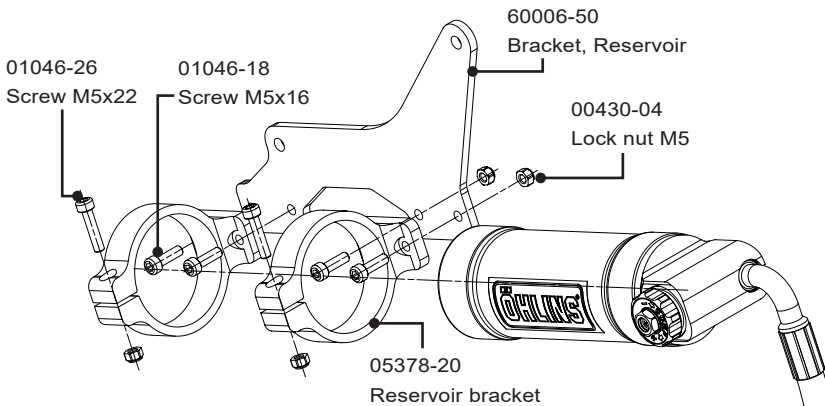

9

9.1 Install the reservoir bracket 05378-20 (10) to the bracket 60006-50 (5) by tightening screws (12) and lock nuts (13) with torque value at 10 Nm.

9.2 Install the reservoir to the reservoir bracket by facing the adjuster knob outward to the side of the vehicle. Clamp the reservoir by tightening screws (11) and lock nuts (13) with torque value at 10 Nm.

MOUNTING INSTRUCTIONS

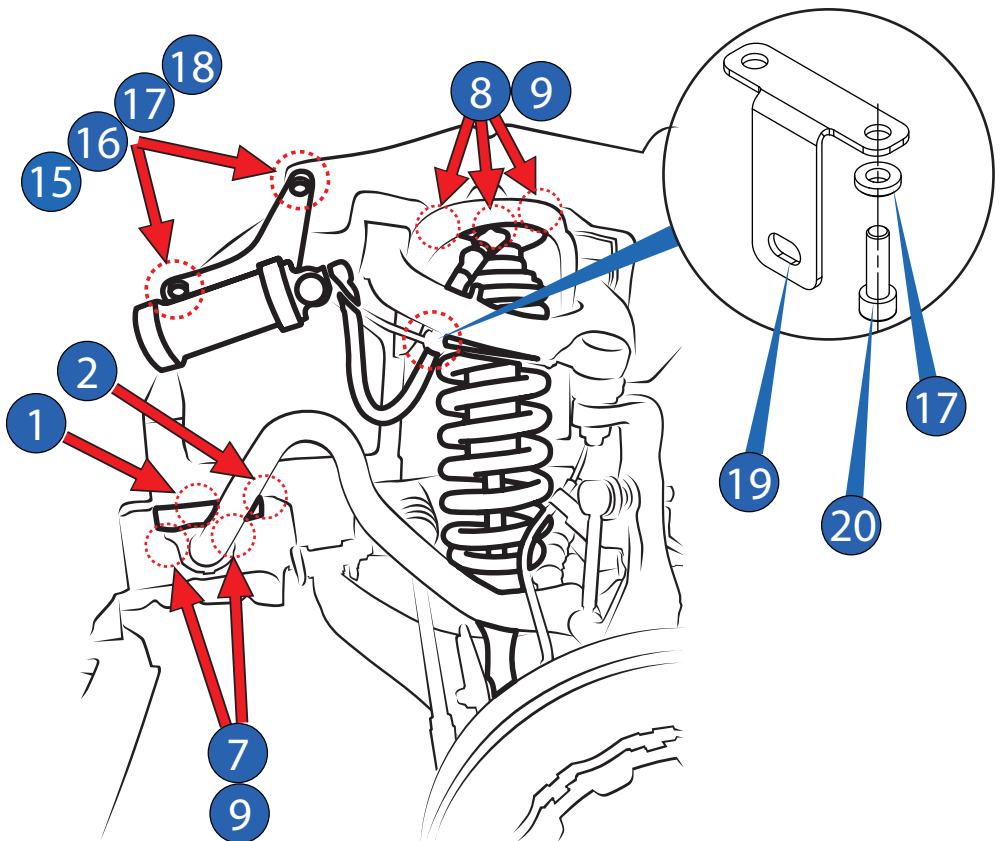

10

10.1 Install the anti-rollbar spacer (6) by tightening the OEM screws ① and ② with torque value as specified in the vehicle service manual.

10.2 Install the clamp by tightening screws (7) and washers (9) with torque value at 30 Nm.

11

11.1 Install the Öhlins shock absorber with the reservoir hose pointing towards the front of vehicle. Tighten top mounting with new screws (8) and washers (9) with torque value at 44 Nm.

11.2 Install the reservoir assembled through the spacer (14) and chassis. Tighten screw (15) with washer (16) and washer (17) with lock nut (18) with torque value at 20 Nm.

11.3 Replace the wiring bracket with Öhlins bracket (19). Tighten screw (20) and washer (17) with torque value at 12 Nm.

11.4 Reverse all the procedures as necessary. Torque value as specified in the vehicle service manual.

Note!

Check the upper wishbone position. It shall not engage the upper wishbone stopper when the suspension is fully extend

ADJUSTMENTS

⚠ Warning!

Before driving, always make sure that the basic settings made by Öhlins are according to recommended Set-up Data. Read about adjustments and setting up in the Öhlins Owner's Manual before you make any adjustments. Contact an Öhlins dealer if you have any questions about setting up.

👁 Note!

Apply penetrating oil (WD-40 or similar) to preload adjuster when preload adjustment needed.

👁 Note!

Recheck the vehicle wheel alignment after installation.

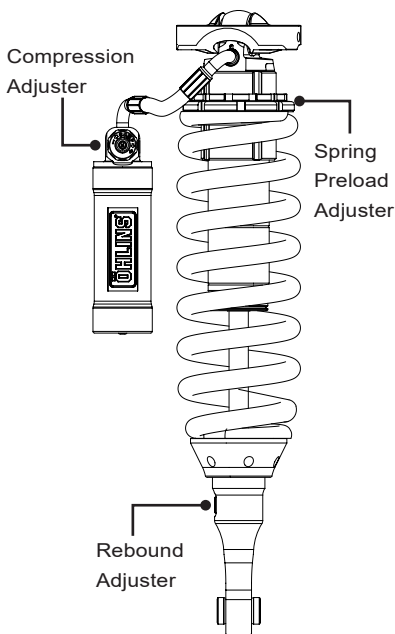

SET-UP DATA

Recommended set-up

Paved roads/highway:	
Compression Adjuster	12 Clicks
Rebound Adjuster	12 Clicks
Gravel roads/offroad:	
Compression Adjuster	15 Clicks
Rebound Adjuster	20 Clicks

Shock absorber data

Length	531 mm
Stroke	128 mm

Spring options			
Part No.	62462-11	62462-04	62462-02
Free spring length	325 mm	325 mm	315 mm
Spring rate	110 N/mm	120 N/mm	130 N/mm
Preload adj.range	[10-38] mm	[10-33] mm	[0-28] mm
Recommended preload (0" Lift)	17 mm	12 mm	7 mm
Recommended preload (1" Lift)	30 mm	25 mm	20 mm
Vehicle equipment	Standard	Light bull bar Up to 50 kg.	Heavy bull bar + Winch Up to 100 kg.

👁 Note!

Recommended preload is up to 35 mm lift regarding to suspension components limitation.

👁 Öhlins products are subject to continuous improvement and development, therefore, although these instructions include the most up-to-date information available at the time of printing, minor updates may occur.

To find the latest information contact an Öhlins distributor. Please contact Öhlins if you have any questions regarding the contents in this document.

Part no. MI_Isuzu D-Max_EN_0
Issued 2022-11-08

© Öhlins Asia Co. Ltd. All rights reserved. Any reprinting or unauthorized use without the written permission of Öhlins Racing AB is prohibited.

Öhlins Asia Co. Ltd
700/937 Moo5, Tambol Nongkhaga,
Amphur Phantong, Chonburi Province
20160 Thailand



www.ohlins.com

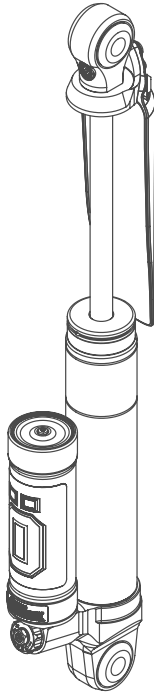

👁 Note!

Before installing this product, check the contents of the kit. If anything is missing, please check an Öhlins dealer.

Kit Contents

	Description	Part No	Pcs
1	Shock absorber	ISV 6X00	2
2	Washer	62436-04	4
3	Lift block	62417-25	2
4	Pin	62418-02	2

👁 Note!

Please note that this image is a general representation of the product and may differ slightly from your product.

👁 Note!

Please note that during storage and transportation, especially at high ambient temperature, some of the oil and grease used for assembling may leak and stain the packaging. This is in no way detrimental to the product, wipe off the excessive oil/grease with a cloth.

⚠ Warning!

Before installing this product, read the Öhlins Owner's Manual. The shock absorber is an important part of your vehicle and will affect the stability.

Shock Absorber Kit for Isuzu D-Max RG Rear

ISV 6X00

Mounting Instructions

MOUNTING INSTRUCTIONS

⚠ Caution!

Before removing the rear shock absorber, please use lift jack to hold the drive shaft in a good position.

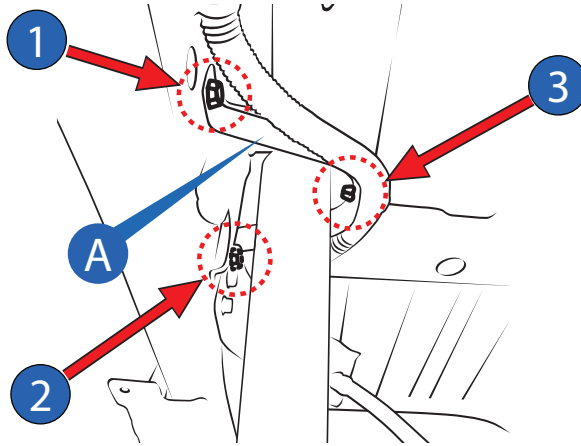

1

1.1 Remove the wiring bracket **A** by loosening screws **1** and **2** then remove the wiring clips **3** out of the wiring bracket.

1.2 Put the wiring cable located above the upper shock absorber mounting.

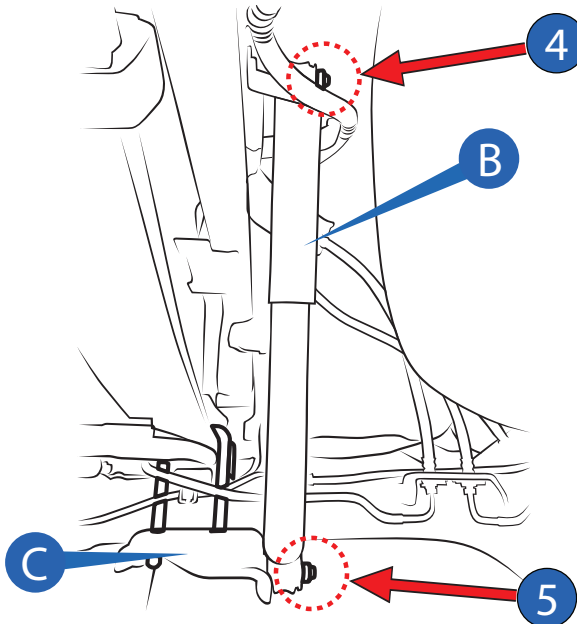

2

2.1 Remove OEM rear shock absorber **B** by loosening screws **4** and **5**.

2.2 Remove U-bolt spring seats **C** by loosening 4 nuts underneath then remove 2 U-bolts.

MOUNTING INSTRUCTIONS

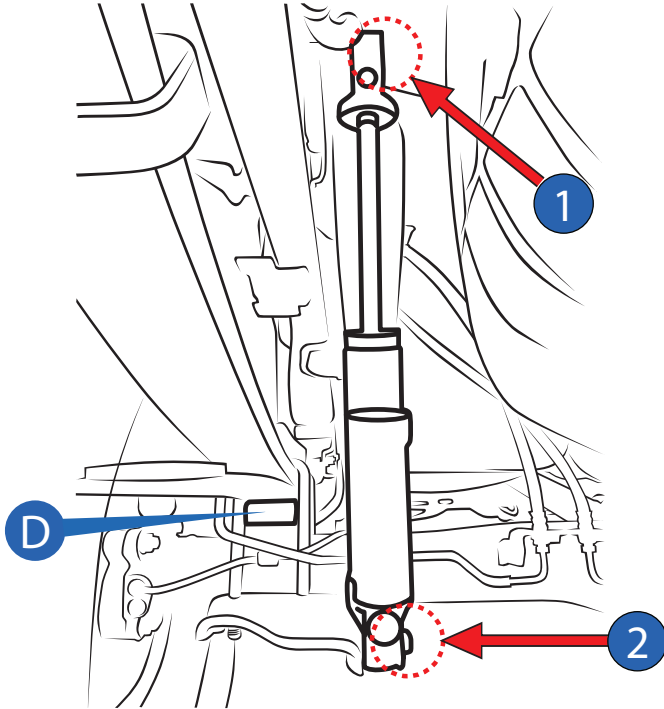

👁 Note!

U-bolts are not supplied in the kit. Please ask Öhlins dealers for recommendation.

3

3.1 Install the lift block assembled with pin **D** in between leaf spring and rear axle.

3.2 Replace the new 25 mm longer U-bolts then tighten 4 nuts underneath with torque value as specified in the vehicle service manual.

3.3 Install the rear shock absorbers sequentially according to the picture below. Starting from OEM washer, shock absorber (1), washer (2) and OEM nut then tighten nuts **1** and **2** with torque value as specified in the vehicle service manual.

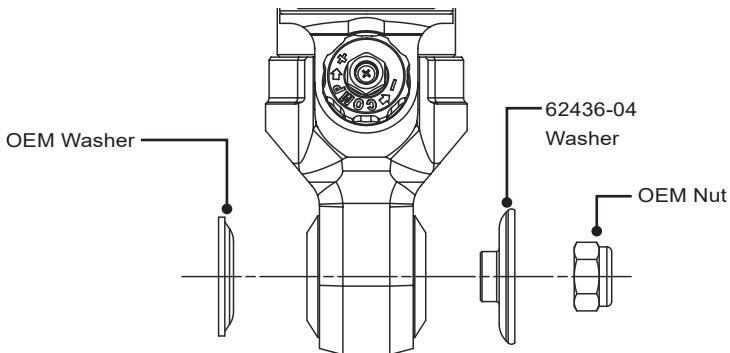

ADJUSTMENTS

⚠ Warning!

Before riding, always make sure that the basic settings made by Öhlins are according to recommended Set-up Data. Read about adjustments and setting up in the Öhlins Owner's Manual before you make any adjustments. Contact an Öhlins dealer if you have any questions about setting up.

👁 Note!

Recheck the vehicle wheel alignment after installation.

SET-UP DATA

Recommended set-up

Paved roads/highway:	
Compression Adjuster	12 Clicks
Rebound Adjuster	20 Clicks

Gravel roads/offroad:	
Compression Adjuster	16 Clicks
Rebound Adjuster	25 Clicks

Shock absorber data

Length 606 mm

Stroke 215 mm

Lift information

Standard ride height	Do not install Öhlins lift block
1" Lift	Install Öhlins lift block

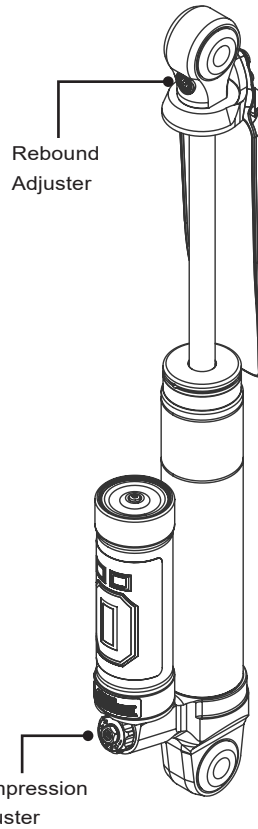

👁 Öhlins products are subject to continuous improvement and development, therefore, although these instructions include the most up-to-date information available at the time of printing, minor updates may occur.

To find the latest information contact an Öhlins distributor. Please contact Öhlins if you have any questions regarding the contents in this document.

Part no. MI_Isuzu D-Max_EN_0
Issued 2022-11-08

© Öhlins Asia Co. Ltd. All rights reserved. Any reprinting or unauthorized use without the written permission of Öhlins Racing AB is prohibited.

Öhlins Asia Co. Ltd
700/937 Moo5, Tambol Nongkhaga,
Amphur Phantong, Chonburi Province
20160 Thailand



www.ohlins.com