

**SHOCK ABSORBER KIT FOR**  
**ISUZU Mu-X RJ**

---

Front Shock Absorber Kit.....Page 1-10

Rear Shock Absorber Kit.....Page 13-18

Mounting Instructions



This page is intentionally left blank

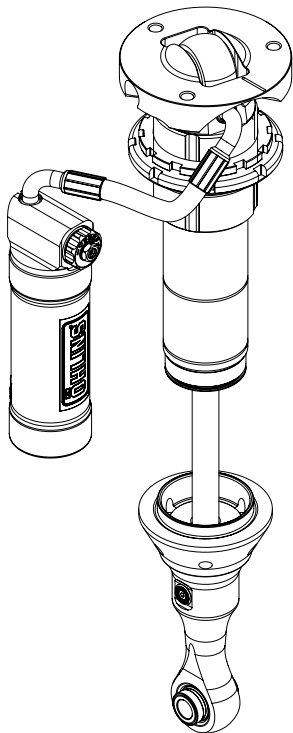

**Note!**

Please note that this image is a general representation of the product and may differ slightly from your product.

**Note!**

Please note that during storage and transportation, especially at high ambient temperature, some of the oil and grease used for assembling may leak and stain the packaging. This is in no way detrimental to the product, wipe off the excessive oil/grease with a cloth.

**Note!**

Before installing this product, check the contents of the kit. If anything is missing, please check an Öhlins dealer.

**Kit Contents**

Description	Part No	Pcs
1.1 Shock absorber LH	ISV 1X50	1
1.2 Shock absorber RH	ISV 2X50	1
2 Washer	00543-12	2
3 Spring clip	62429-01	2
4 Lock ring	62427-01	4
5 Bracket, Reservoir	60006-50	2
6 Spacer	61125-10	2
7 Screw M10x25x1.25	00429-33	4
8 Screw M10x25x1.5	00429-34	6
9 Washer	00426-08	10
10 Reservoir bracket	05378-20	4
11 Screw M5x22	01046-26	4
12 Screw M5x16	01046-18	8
13 Lock nut M5	00430-04	12
14 Spacer	60049-05	4
15 Screw M6x25x1.0	01046-17	4
16 Washer	00426-04	4
17 Washer	00426-07	6
18 Lock nut M6	00430-02	4
19 Bracket	60006-51	2
20 Screw M6x20x1.0	01046-16	2
21 C-Spanner	60710-03	1
22 R&T C-Spanner	01796-01	1
23 Sticker set "ÖHLINS"	10207-01	1
24 Owners manual	07440-06	1

**Warning!**

Before installing this product, read the Öhlins Owner's Manual. The shock absorber is an important part of your vehicle and will affect the stability.

**Shock Absorber Kit for Isuzu Mu-X RJ Front**

**ISV 1X50**

**ISV 2X50**

**Mounting Instructions**



# MOUNTING INSTRUCTIONS

**⚠ Warning!**

*It is advisable to have an Öhlins dealer install the shock absorber.*

**⚠ Warning!**

*If working on a raised vehicle, ensure it is securely supported so that it will not tip over.*

**👁 Note!**

*Before mounting this product clean the vehicle thoroughly.*

**👁 Note!**

*When working on this product, always see the Vehicle Service Manual for vehicle specific procedures and important data.*

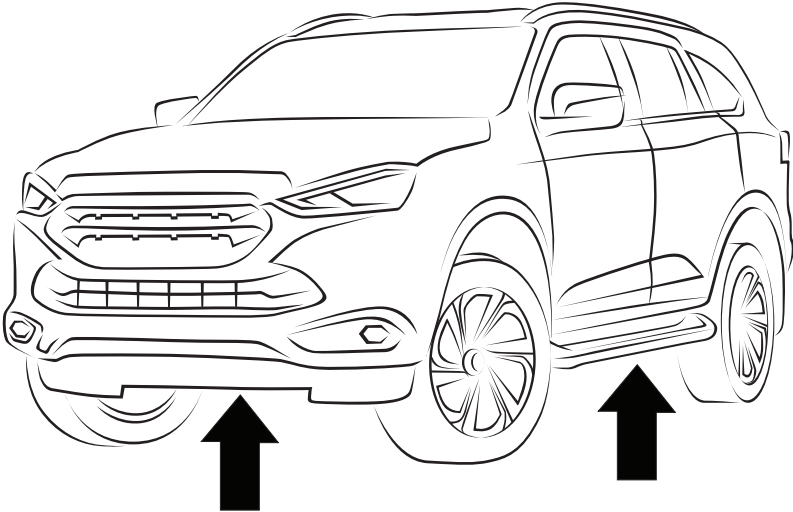

1

Lift the vehicle by using a suitable car lift.

**👁 Note!**

*Refer to the vehicle service manual for the recommended lift points.*

2

Remove the front wheels.



# MOUNTING INSTRUCTIONS

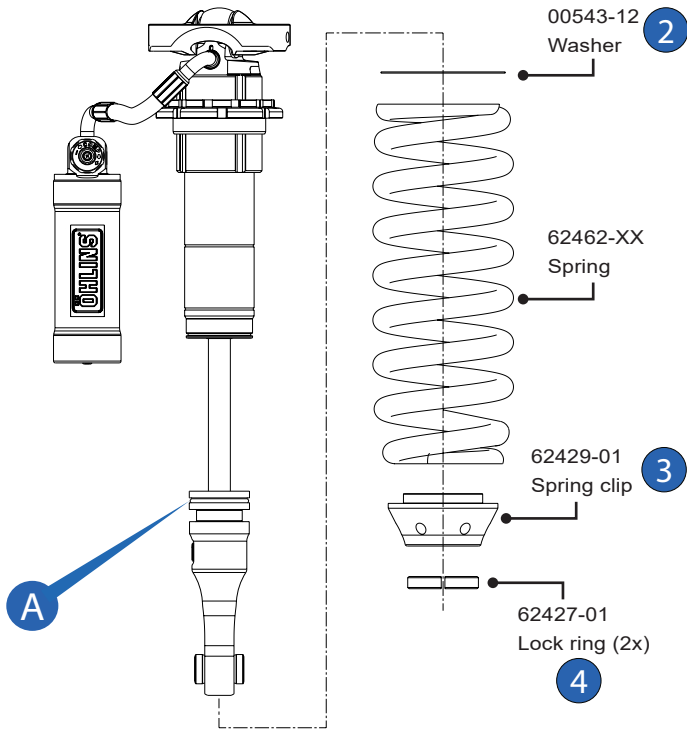

## 3 Spring Installation

3.1 Pre-compress the spring by using a spring compressor.

3.2 Install the washer (2) underneath the pre-load adjuster nuts.

3.2 Install the spring onto the damper body.

3.3 Apply penetrating oil (WD-40 or similar) to the O-ring (A) then install the spring clip (3) through the end-eye and lock it in place by using the 2 lock rings (4).

### **Note!**

*For spring recommendation and preload see page 10.*

# MOUNTING INSTRUCTIONS

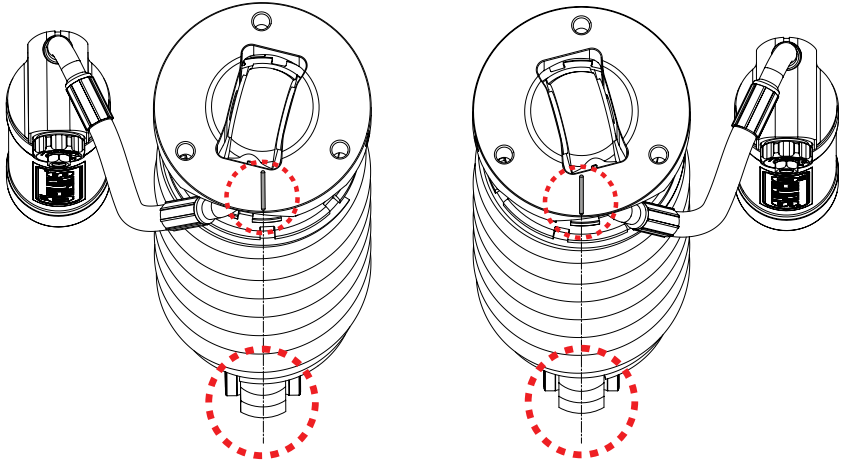

Left Side

Right Side

👁 **Note!**

---

*Make sure that the end eye direction is aligned with the marking on the top plate.*

*Release the spring from the spring compressor making sure the spring clip and the lock rings are seated properly.*

---

👁 **Note!**

---

*When installing the springs, the rebound adjuster must be oriented towards the front of the vehicle.*

---

# MOUNTING INSTRUCTIONS

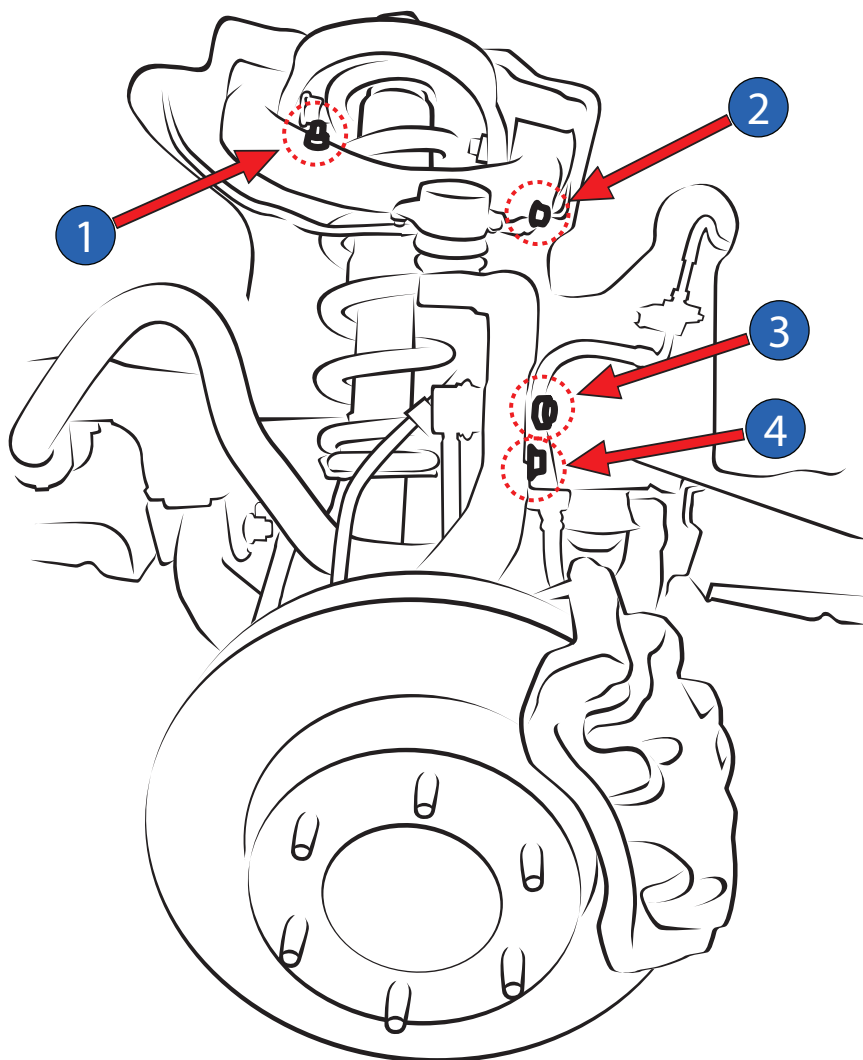

4

Loosen the wiring cable bracket screws ①, ② and the anti-rollbar link ③ then loosen brake line bracket screw ④.

# MOUNTING INSTRUCTIONS

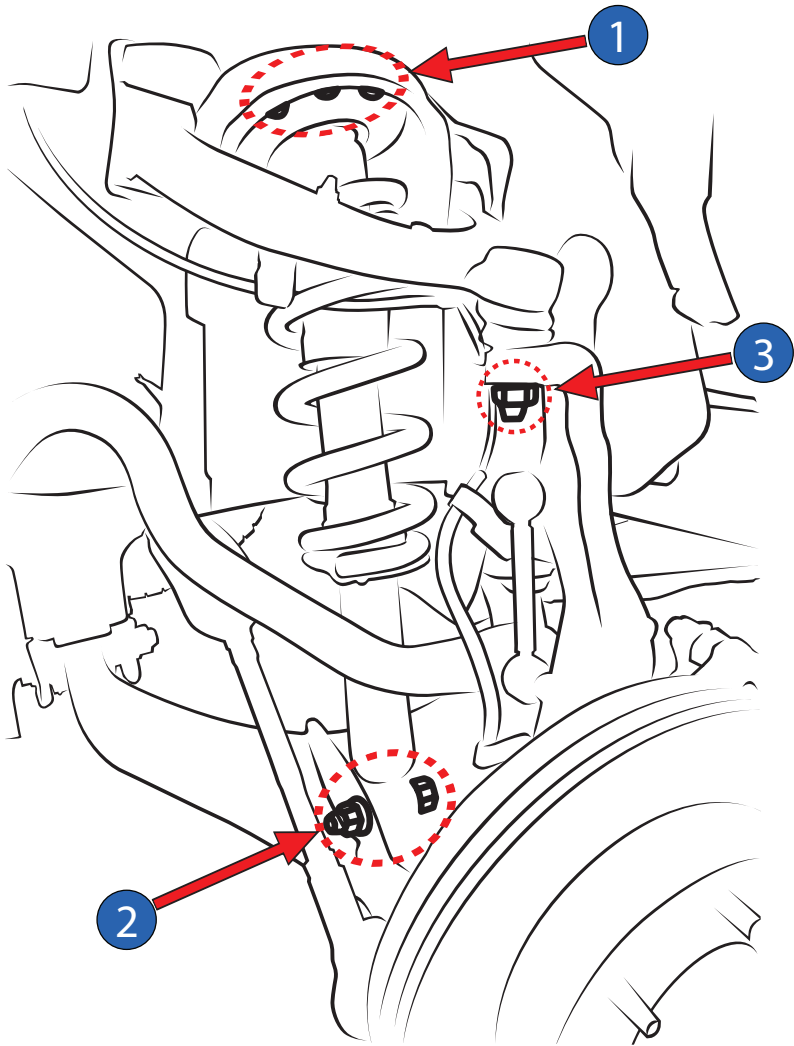

5  
Loosen the 3 top mount screws ① and lower mount screw ②. Then loosen the upper control arm ball joint screw ③.

# MOUNTING INSTRUCTIONS

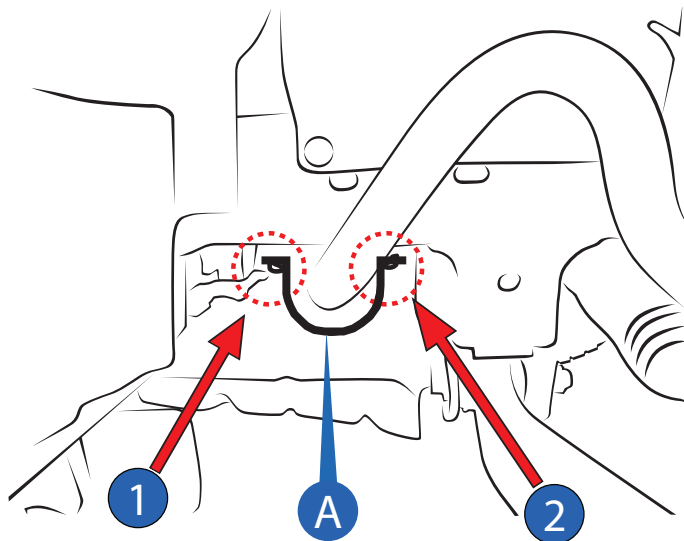

6

Remove the OEM Anti-rollbar clamp bracket **A** by loosening the screws **1** and **2**.

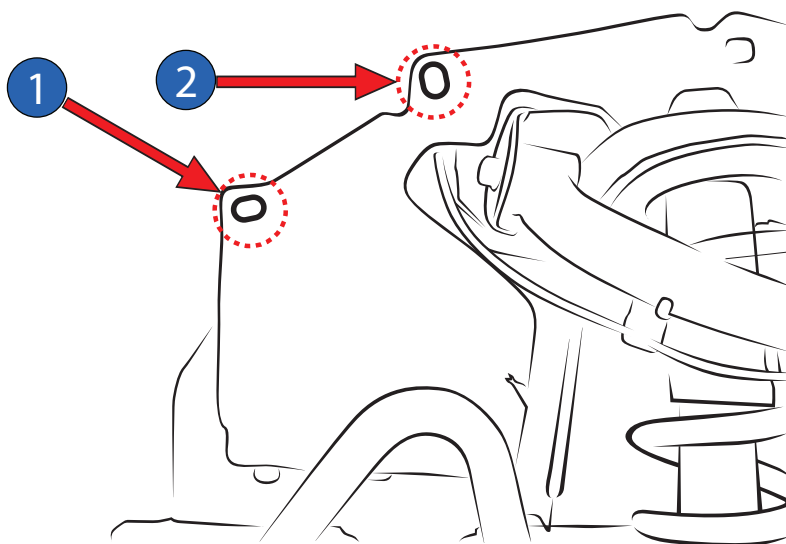

7

Remove the plastic clips **1** and **2**.

# MOUNTING INSTRUCTIONS

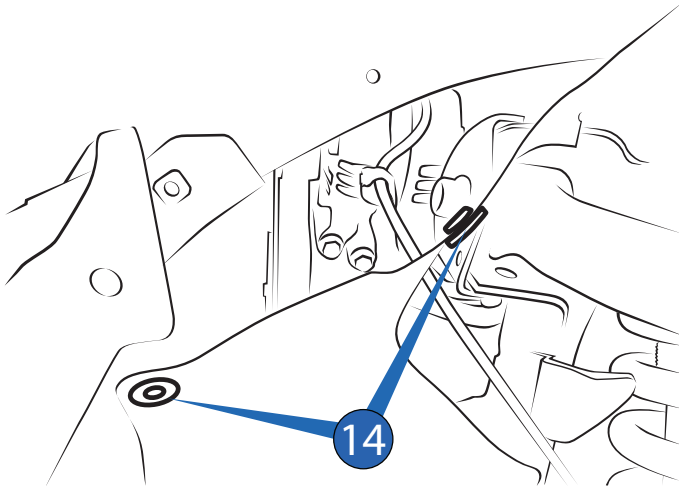

8  
Install the 2 spacers P/No (14) to the rubber cover replacing the plastic clips and facing the bigger diameter side outwards from the vehicle.

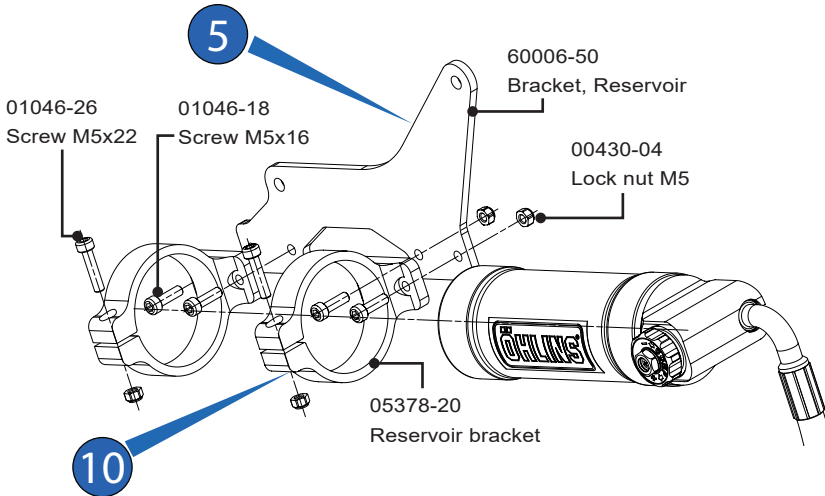

9  
9.1 Install the reservoir bracket (10) to the bracket (5) by tightening screws (12) and lock nuts (13) with torque value at 10 Nm.  
9.2 Install the reservoir to the reservoir bracket by facing the adjuster knob outward to the side of the vehicle. Clamp the reservoir by tightening screws (11) and lock nuts (13) with torque value at 10 Nm.

# MOUNTING INSTRUCTIONS

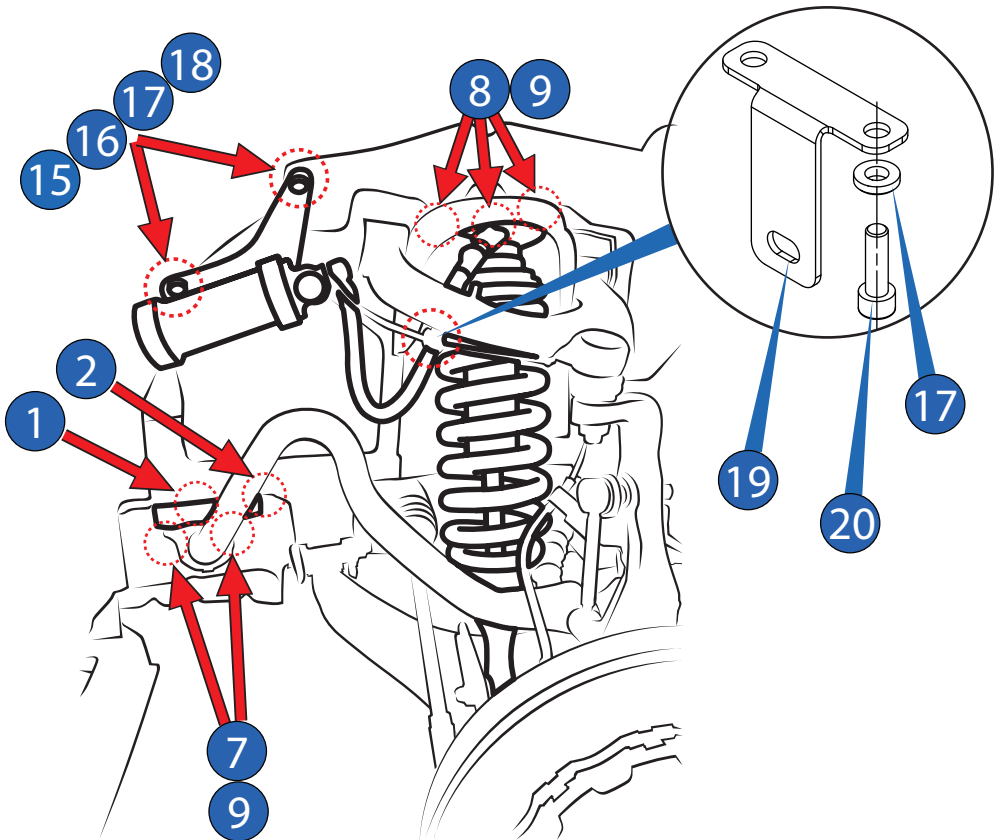

10

10.1 Install the anti-rollbar spacer (6) by tighten the OEM screws ① and ② with torque value as specified in the vehicle service manual.

10.2 Install the clamp by tighten screws (7) and washers (9) with torque value at 30 Nm.

11

11.1 Install the Öhlins shock absorber with the reservoir hose pointing towards the front of vehicle. Tighten top mounting with new screws (8) and washers (9) with torque value at 44 Nm.

11.2 Install the reservoir assembled through the spacer (14) and chassis. Tighten screw (15) with washer (16) and washer (17) with lock nut (18) with torque value at 20 Nm.

11.3 Replace the wiring bracket with Öhlins bracket (19). Tighten screw (20) and washer (17) with torque value at 12 Nm.

11.4 Reverse all the procedures as necessary. Torque value as specified in the vehicle service manual.

## 👁 **Note!**

*Please check the upper wishbone position. it should not engage the upper wishbone stopper when fully extend position*

# ADJUSTMENTS

## ⚠ Warning!

Before driving, always make sure that the basic settings made by Öhlins are according to recommended Set-up Data. Read about adjustments and setting up in the Öhlins Owner's Manual before you make any adjustments. Contact an Öhlins dealer if you have any questions about setting up.

## 👁 Note!

Apply penetrating oil (WD-40 or similar) to preload adjuster when preload adjustment needed.

## 👁 Note!

Recheck the vehicle wheel alignment after installed.

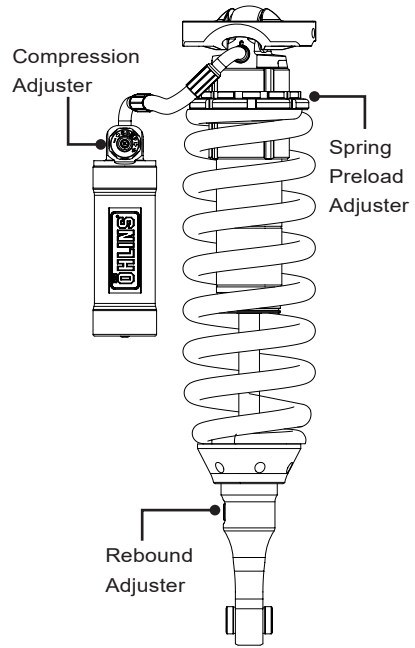

### Shock absorber data

Length ..... 520 mm  
Stroke ..... 121 mm

# SET-UP DATA

## Recommended set-up

Paved roads/highway:	
Compression Adjuster	12 Clicks
Rebound Adjuster	18 Clicks
Gravel roads/offroad:	
Compression Adjuster	18 Clicks
Rebound Adjuster	20 Clicks

### Spring options

Part No.	62462-10	62462-01	62462-02
Free spring length	315 mm	315 mm	315 mm
Spring rate	110 N/mm	120 N/mm	130 N/mm
Preload adj.range	[8-39] mm	[8-34] mm	[8-34] mm
Recommended preload	22 mm	18 mm	14 mm
Vehicle equipment	Standard	Light bull bar Up to 50 kg.	Heavy bull bar + Winch Up to 100 kg.

👁 Öhlins products are subject to continuous improvement and development, therefore, although these instructions include the most up-to-date information available at the time of printing, minor updates may occur.

To find the latest information contact an Öhlins distributor. Please contact Öhlins if you have any questions regarding the contents in this document.

Part no. MI\_Isuzu Mu-X\_EN\_2  
Issued 2023-07-13

© Öhlins Asia Co. Ltd. All rights reserved. Any reprinting or unauthorized use without the written permission of Öhlins Racing AB is prohibited.

Öhlins Asia Co. Ltd  
700/937 Moo5, Tambol Nongkhaga,  
Amphur Phantong, Chonburi Province  
20160 Thailand



[www.ohlins.com](http://www.ohlins.com)



This page is intentionally left blank

This page is intentionally left blank

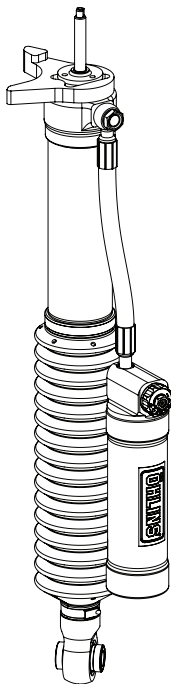

**Note!**

Please note that this image is a general representation of the product and may differ slightly from your product.

**Note!**

Please note that during storage and transportation, especially at high ambient temperature, some of the oil and grease used for assembling may leak and stain the packaging. This is in no way detrimental to the product, wipe off the excessive oil/grease with a cloth.

**Note!**

Before installing this product, check the contents of the kit. If anything is missing, please check an Öhlins dealer.

**Kit Contents**

Description	Part No	Pcs
1.1 Shock absorber LH	ISV 3X50	1
1.2 Shock absorber LH	ISV 4X50	1
2 Reservoir bracket	60006-52	2
3 Hose bracket	60006-53	1
4 Spring holder	61125-14	2
5 Washer	63118-12	2
6 Washer	60426-02	2
7 Screw M12x100	00429-38	3
8 Washer	60426-06	3
9 Washer	60426-05	5
10 Lock nut M12	00430-08	3
11 Screw M12x20	00429-37	2
12 Reservoir clamp	05378-20	4
13 Screw M5x16	01046-18	8
14 Screw M5x25	01046-26	4
15 Lock nut M5	00430-04	12
16 Screw M10x40	00429-01	2
17 Washer	00426-08	2
18 Flange nut M10	00430-09	2

**Warning!**

Before installing this product, read the Öhlins Owner's Manual. The shock absorber is an important part of your vehicle and will affect the stability.

## Shock Absorber Kit for Isuzu Mu-X RJ Rear

# ISV 6X50

## Mounting Instructions

# MOUNTING INSTRUCTIONS

## ⚠ Caution!

Before removing the rear shock absorber, please use lift jack to hold the drive shaft in a safe position.

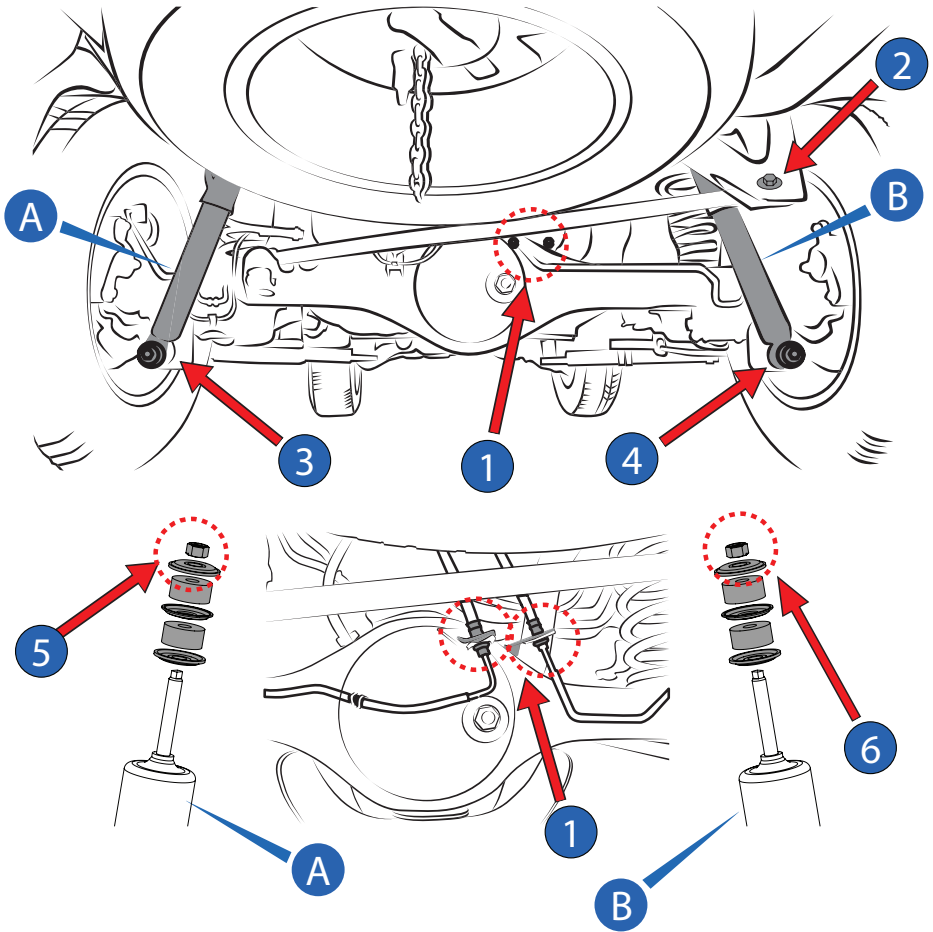

### 1 Rear shock absorbers and springs removal

1.1 Unclamp the brake lines from the bracket by removing the clips ① .

1.2 Loosen the screw ② at the linkage.

1.3 Remove the OEM rear shock absorbers ④ and ⑤ by loosening the lower mounting screws ③ and ④ then loosening the upper mounting nuts ⑤ and ⑥.

1.4 Drop the rear axle downward then remove the OEM rear spring

# MOUNTING INSTRUCTIONS

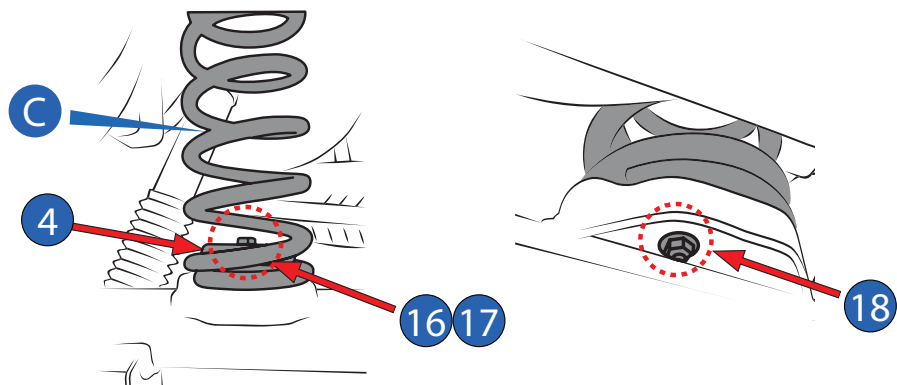

2

2.1 Install Ohlins springs ©.

2.2 Install the spring holder (4) by tightening the screw (16), washer (17) and flange nut (18) with 30 Nm torque.

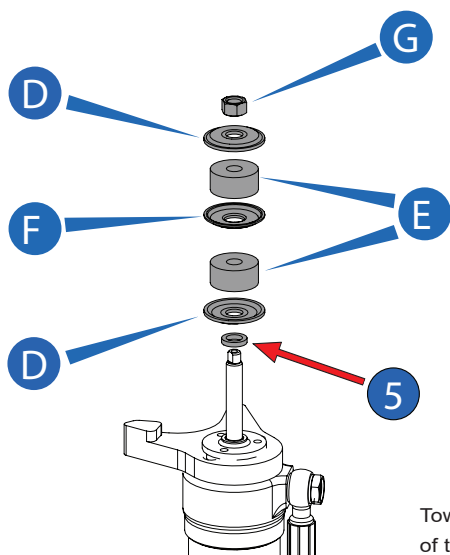

2.3 Assemble the Öhlins rear shock absorbers with the Ohlins washer (5), OEM washers © and OEM rubbers ©, then tighten the OEM nut © with a torque value at 50 Nm (See the picture above).

# MOUNTING INSTRUCTIONS

2.4 Install the lower mounting by sequential assembling according to the picture below then tighten the OEM nut (H) and the washer (6) with torque value as specified in the vehicle service manual.

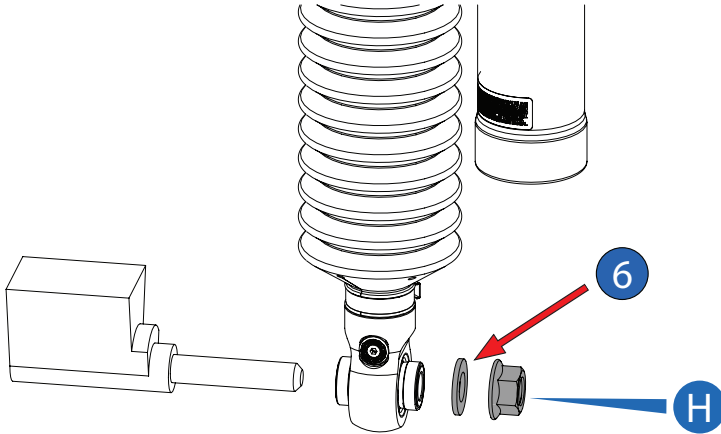

## 3 Reservoir bracket installation.

3.1 Assemble the reservoir clamp(12) to the reservoir bracket (2) by tightening the screws M5(13) with the lock nuts M5 (15) with the torque value 10 Nm.

### 👁 **Note!**

*Ensure the nut socket on the reservoir clamps are upward.*

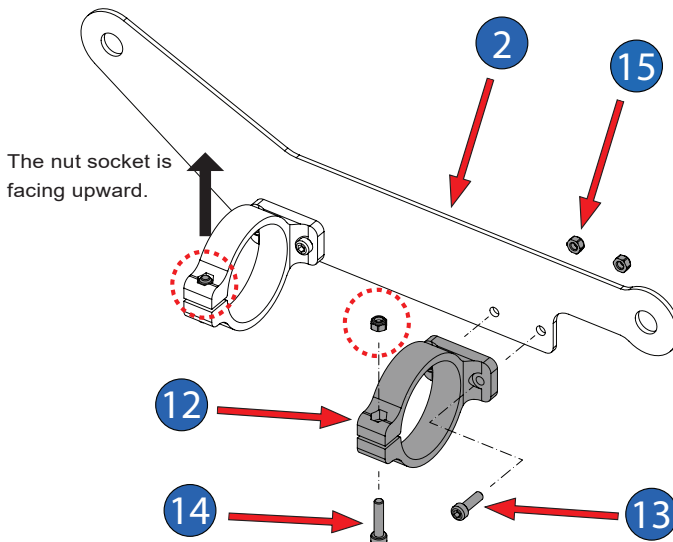

# MOUNTING INSTRUCTIONS

3.2 Install the reservoir brackets (2) for the left and right side with the screws M12 (7) (11), washers (8) (9) and the lock nuts (10), then install the the hose bracket (3) only the right side by the screw M12 (7) together with the washers (8) (9) and lock nuts (10) into the chassis, (see the picture below).

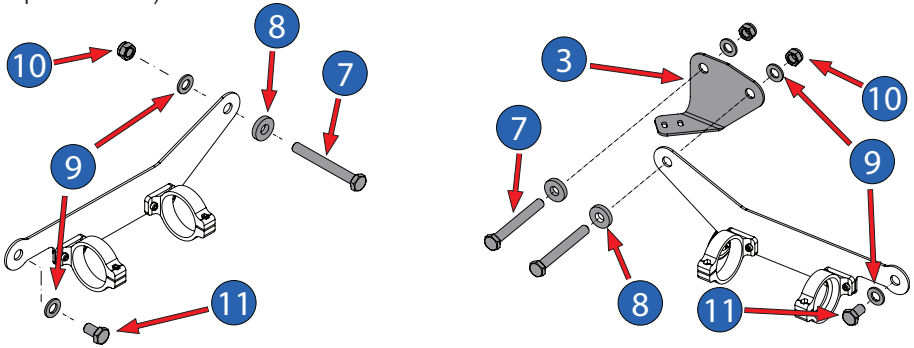

3.3 Routing the reservoir hoses for the left and right hand side according to the pictures below.

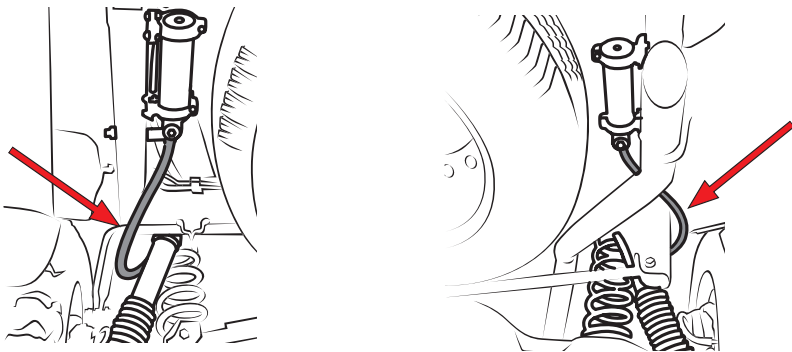

3.4 Install the reservoirs into the reservoir clamps (12) then clamp with the screws M5 (14) and the lock nuts (15) by tightening the 10 Nm torque value. Please see the picture below.

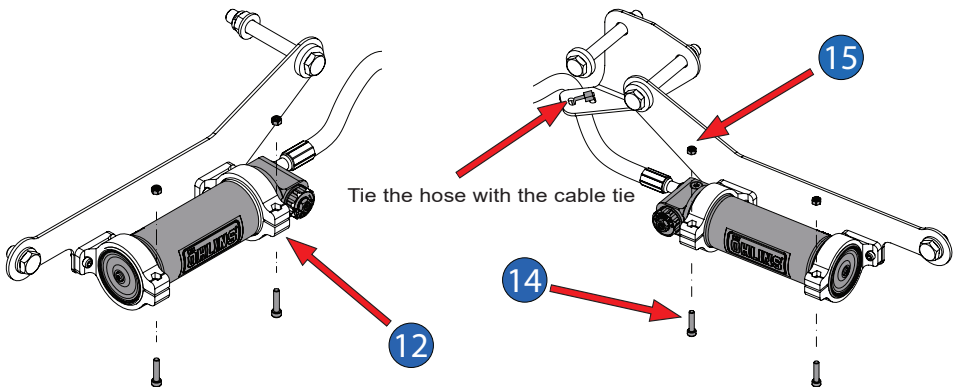

# ADJUSTMENTS

## ⚠ Warning!

Before riding, always make sure that the basic settings made by Öhlins are according to recommended Set-up Data. Read about adjustments and setting up in the Öhlins Owner's Manual before you make any adjustments. Contact an Öhlins dealer if you have any questions about setting up.

## 👁 Note!

Recheck the vehicle wheel alignment after installed.

# SET-UP DATA

### Recommended set-up

Paved roads/highway:	
Compression Adjuster	15 Clicks
Rebound Adjuster	25 Clicks

Gravel roads/offroad:	
Compression Adjuster	20 Clicks
Rebound Adjuster	25 Clicks

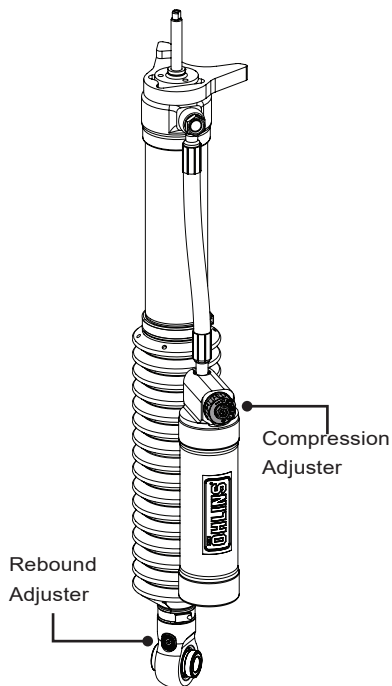

### Shock absorber data

Length ..... 561.5 mm  
Stroke ..... 200 mm

Spring options		
Part No.	62474-04	62474-09
Free spring length	375 mm	355 mm
Spring rate	40 N/mm	50 N/mm
Driving conditions	Comfort	Standard/ light load

👁 Öhlins products are subject to continuous improvement and development, therefore, although these instructions include the most up-to-date information available at the time of printing, minor updates may occur.

To find the latest information contact an Öhlins distributor. Please contact Öhlins if you have any questions regarding the contents in this document.

Part no. MI\_Isuzu Mu-X\_EN\_2  
Issued 2023-07-13

© Öhlins Asia Co. Ltd. All rights reserved. Any reprinting or unauthorized use without the written permission of Öhlins Racing AB is prohibited.

Öhlins Asia Co. Ltd  
700/937 Moo5, Tambol Nongkhaga,  
Amphur Phantong, Chonburi Province  
20160 Thailand



[www.ohlins.com](http://www.ohlins.com)